

Prominent Downtown Corner Space

For Lease by Owner
Shane Ikola | 231.690.2163



Your Signage Here
(subject to required approvals)

Lease Details

- Asking Rate:** \$11/SF/year (Approx \$3,036/Month)
- Lease Type:** Modified Gross
- Asking Term:** 36-60 month
- Possession:** At lease signing
- Landlord Pays:** Taxes, Insurance, Water/Sewer, Parking Lot Maintenance
- Tenant Pays:** Electric, Gas, Phone/Data, Trash/Refuse Removal, Insurance

Space Details:

- Size:** Approx 3,312 SF*
- Zoning:** C-3 Central Business District
- Current Use:** Retail; Vacant
- Signage:** On building at tenant's expense, subject to municipal ordinance and approvals.
- Parking:** Private parking lot and on-street available
- Comments:** Commercial space available in the heart of historic downtown Manistee. Prominent corner next to City Hall and located across from the Ramsdell Inn/Tj's Pub, Gliks, WSCC building, and a Manistee Riverwalk access point at Maple Street Bridge. Private on site parking available. Building is located in Manistee's Social District.

* Available Space smaller due to stairwell in back.

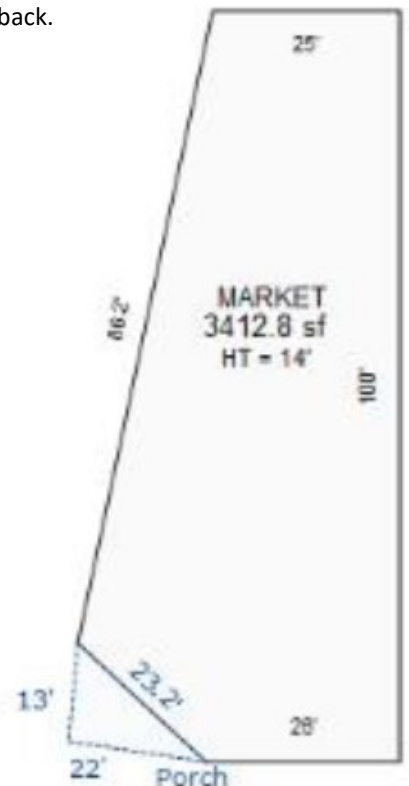

ccp 13 x 22 = 1/2 143 sq ft

FIRST FLOOR

